

CERTIFIED RECORD OF LAND CORNER MONUMENTATION

History of original corner establishment:

Z-19

Corner originally established by Alonzo Gesner, U.S. Deputy Surveyor, under GLO Contract No. 266 dated June 20, 1877. Surveyor General records state:

Set stone 16 x 8 x 6 ins. for 1/4 Section corner. Raised stone mound at corner.

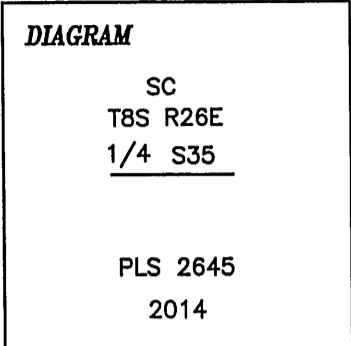

Description of corner evidence found:

No original evidence found. Monument set by single proportion. See Record Map of Survey No. 2026

Description of monument and accessories I established to perpetuate the original location of this corner:

Set a 3" x 30" aluminum pipe with a 3 1/4" aluminum cap marked as shown in a 1' collar of stone. A magnet in a clear plastic case was deposited at the base of pipe. Cap is 1" above the collar of stone.

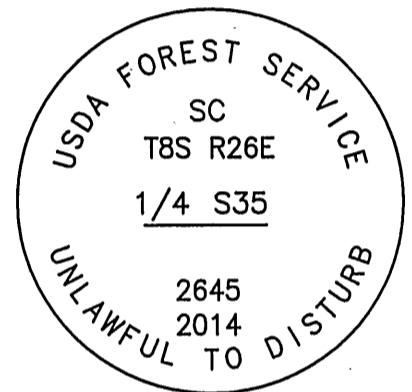

New accessories:

- A 1/2" x 30" rebar with red plastic cap marked "UMNF RM1" bears N48°W, 16.23'.
- A 1/2" x 30" rebar with red plastic cap marked "UMNF RM2" bears N53°E, 21.82'.

Geodetic Coordinates (NAD83):

N 44°49'26.6"
W 119°34'56.9"

Geodetic coordinates were obtained from a Garmin recreational grade GPS receiver and were averaged.

Date: July 22, 2014

Declination: 17° E

Witnesses: Paul Guglielmelli, Lisa Adair, Lucas Beauchamp, Daniel Lee, and Toribio Quinones

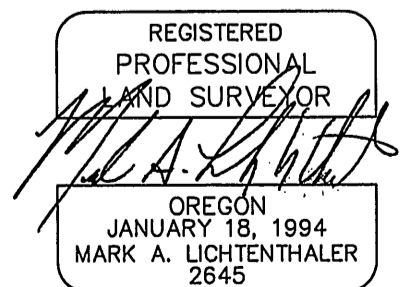

EXPIRES 12-31-2018